

CORNER RECORD

Document Number CR 9837

City of OAKLAND

County of ALAMEDA, California

Brief Legal Description IRON PIN MONUMENT LOCATED WITHIN THE INTERSECTION OF
FRUITVALE AVENUE AND SCHOOL STREET.

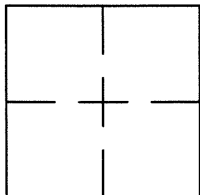

CORNER RECORD

Government Corner ☐ Control ☒
Meander ☐ Property ☐
Rancho ☐ Other ☐
Date of Survey 2/13/17

COORDINATES
(Optional)

N. _____
E. _____
Zone _____ Datum _____
Elev. _____

Corner — Left as found ☒ Found and tagged ☐ Established ☐ Reestablished ☐ Rebuilt ☐

Identification and type of corner found: Evidence used to identify or procedure used to establish or reestablish the corner:
FOUND IRON PIN IN MONUMENT WELL LOCATED WITHIN THE INTERSECTION OF
FRUITVALE AVENUE AND SCHOOL STREET.

THIS POINT WAS REFERENCED PRIOR TO A CONSTRUCTION PROJECT IN THE VICINITY.

A description of the physical condition of the monument as found and as set or reset: _____
FOUND AND SET POINTS AS SHOWN ON PAGE 2.

THE TIES SHOWN HEREON ARE FOR THE PURPOSE OF PERPETUATING FOUND MONUMENTATION.

NO CLAIM IS MADE AS TO THE RELATIONSHIP OF THE POINTS OR LINES SHOWN HEREON TO
TRUE BOUNDARY LOCATIONS.

SURVEYOR'S STATEMENT

This Corner Record was prepared by me or under my direction in conformance with
the Land Surveyors' Act on FEBRUARY 22, 2017.

Signed Scott V. Cunha L.S. Number LS 8525
SCOTT V. CUNHA

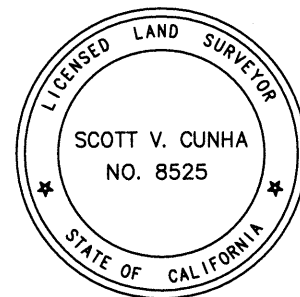

COUNTY SURVEYOR'S STATEMENT

This Corner Record was received 20 MARCH 2017 and examined
and filed 16 JUNE 2017.

Signed Michael Rubner Title COUNTY SURVEYOR

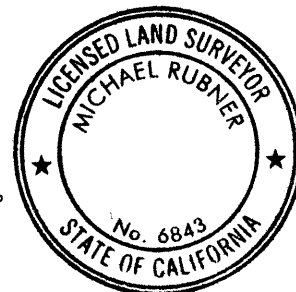

County Surveyor's Comment _____

LEGEND

-