

CORNER RECORD

Agency Index

BK 141 PG 37

Document Number

CR 15105

City of **BERKELEY**

County of **ALAMEDA**

California

Brief Legal Description **LOT 22, BLOCK 125 CORRECTED MAP OF RAYMOND TRACT (10 M 12)**

CORNER TYPE

COORDINATES (Optional)

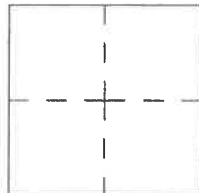

Government Corner ☐ Control ☐
Meander ☐ Property ☒
Rancho ☐ Other ☐

N. _____ E. _____

Elevation. _____

Units Metric ☐ U.S. Survey Foot ☐

Horizontal Datum _____

Zone _____ Epoch Date _____

Date of Survey **FEBRUARY 17, 2021**

Vertical Datum _____

☐ Complies with Public Resources Code §§8801-8819

☐ Complies with Public Resources Code §§8890-8902

PLS Act Ref.:

☒ 8765(d)

☐ 8771

☐ 8773

☐ Other:

Corner/
Monument:

☐ Left as found

☒ Established

☐ Rebuilt

☐ Pre-Construction

☐ Found and tagged

☐ Reestablished

☐ Referenced

☐ Post-Construction

Narrative of corner identified and monument as found, set, reset, replaced, or removed:

☒ See sheet #2 for description(s):

FOUND CITY OF BERKELEY STANDARD MONUMENTS ALONG THE MONUMENT LINE OF CHANNING WAY AT THE INTERSECTION OF 7TH STREET (B0365) AND AT THE INTERSECTION OF 6TH STREET (B0364) AS SHOWN ON PARCEL MAP 10299 (328 M 88), THE BEARING NORTH 75°30'24" EAST AS SHOWN ON SAID PARCEL MAP WAS USED AS THE BASIS OF BEARINGS OF THIS SURVEY. ALSO FOUND CITY OF BERKELEY STANDARD MONUMENT (B0406) AT THE INTERSECTION OF 6TH STREET AND BANCROFT WAY.

PROPERTY LINES ESTABLISHED BY PROPORTIONED MEASUREMENT AS INDICATED BY *, OR BY HOLDING RECORD DISTANCES PER THE CORRECTED MAP OF RAYMOND TRACT (10 M 12).

SURVEYOR'S STATEMENT

This Corner Record was prepared by me or under my direction in conformance with

the Professional Land Surveyor's Act on **17-AUG-2021**

Signed

DAN S. SCOTT III

P.L.S. or R.C.E. No. **7840**



COUNTY SURVEYOR'S STATEMENT

This Corner Record was received

and examined and filed

10/11/2021

Signed

D. Ian Wilson

P.L.S. or R.C.E. No.

7010

Title **ALAMEDA COUNTY SURVEYOR**

County Surveyor's Comment

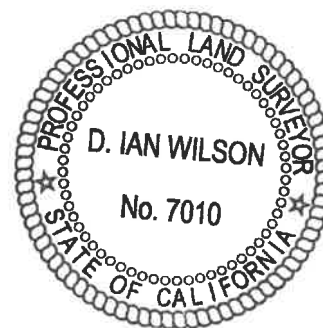

REFERENCE

(R1)- CORRECTED MAP OF RAYMOND TRACT
(10 M 13)
(R2)- PARCEL MAP 10299 (328 M 88)
(R3)- CITY OF BERKELEY MONUMENT CARD

LEGEND

AA**A* - ALAMEDA COUNTY MONUMENT ID
--- CENTERLINE

LEGEND

- - SET NAIL & TAG IN CONC. PLS 7840, UNLESS NOTED.
- - FD. 2" CITY OF BERKELEY BRASS DISK W/PUNCH IN STANDARD MONUMENT BOX, UNLESS NOTED.
- ⊙ - SET 5/8" REBAR AND PLASTIC CAP PLS 7840, UNLESS NOTED.
- SNF - SEARCHED NOTHING FOUND
- * - PRORATED DISTANCE.

GRAPHIC SCALE

