

CORNER RECORD

Agency Index

132/114

Document Number

CR 13727

City of EDEN TOWNSHIP

County of ALAMEDA, California

Brief Legal Description PIN MONUMENT LOCATED WITHIN RALSTON WAY AT RALSTON CT

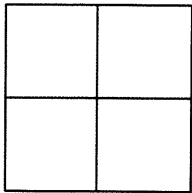

CORNER TYPE

COORDINATES (Optional)

Government Corner ☐ Control ☒
Meander ☐ Property ☐
Rancho ☐ Other ☐

N. _____ E. _____

Elevation _____

Units Metric ☐ U.S. Survey Foot ☐

Horizontal Datum _____

Zone _____ Epoch Date _____

Vertical Datum _____

☐ Complies with Public Resources Code §§8801-8819☐ Complies with Public Resources Code §§8890-8902PLS Act Ref: ☐ 8765 (d) ☒ 8771 ☐ 8773☐ Other: _____

Corner/
Monument: ☒ Left as found ☐ Established ☐ Rebuilt
☐ Found and tagged ☐ Reestablished ☒ Referenced

☐ Pre-Construction☒ Post-Construction

Narrative of corner identified and monument as found, set, reset, replaced, or removed:

☐ See sheet #2 for description (s) : REF 13225

FOUND 1/8" PIN IN CONCRETE IN MONUMENT WELL

FOUND AND SET POINTS AS SHOWN ON PAGE 2.

THIS POINT WAS FOUND IN GOOD CONDITION AFTER A CONSTRUCTION PROJECT IN THE VICINITY.
THE TIES SHOWN HEREON ARE FOR THE PURPOSE OF PERPETUATING FOUND MONUMENTATION.
NO CLAIM IS MADE AS TO THE RELATIONSHIP OF THE POINTS OR LINES SHOWN HEREON TO TRUE
BOUNDARY LOCATION.

SURVEYOR'S STATEMENT

This Corner Record was prepared by me or under my direction in conformance with

the Professional Land Surveyors' Act on SEPTEMBER 23, 2019.

Signed Scott V. Cunha P.L.S. or R.C.E. No. LS 8525
SCOTT V. CUNHA

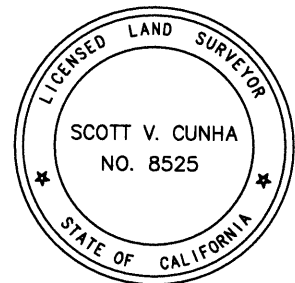

COUNTY SURVEYOR'S STATEMENT

This Corner Record was received APR 09 2020

and examined and filed APR 13 2020

Signed D. Ian Wilson P.L.S. or R.C.E. No. 7010

Title COUNTY SURVEYOR

County Surveyor's Comment

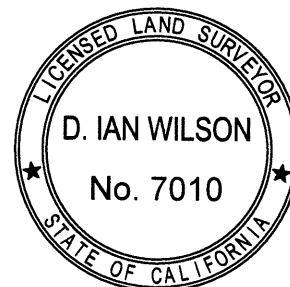

SPEC-2377-POST

SCALE: 1"=30'

LEGEND

- FOUND 1/8" PIN IN CONCRETE IN MONUMENT WELL
- ⊗ FOUND CUT CROSS IN WALK
- AA### ALAMEDA COUNTY MONUMENT ID
- (19592) REFERENCE STREET ADDRESS

