

CORNER RECORD

Agency Index

BK 124 PG 95

Document Number

CR 13287City of FREMONT

County of

ALAMEDA

, California

Brief Legal Description PIN MONUMENT LOCATED WITHIN OLIVE AVE AT CHADBOURNE DR

CORNER TYPE

COORDINATES (Optional)

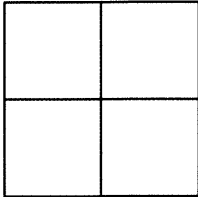

Government Corner

☐

Control

☒

Meander

☐

Property

☐

Rancho

☐

Other

☐

N. _____

E. _____

Elevation _____

Units

Metric ☐U.S. Survey Foot ☐

Horizontal Datum _____

Zone _____

Epoch Date _____

Vertical Datum _____

☐ Complies with Public Resources Code §§8801-8819☐ Complies with Public Resources Code §§8890-8902

PLS Act Ref:

☐

8765 (d)

☒

8771

☐

8773

☐

Other:

Corner/
Monument:☒

Left as found

☐

Established

☐

Rebuilt

☒

Pre-Construction

☐

Found and tagged

☐

Reestablished

☒

Referenced

☐

Post-Construction

Narrative of corner identified and monument as found, set, reset, replaced, or removed:

☐ See sheet #2 for description (s):

FOUND 1/8 PIN IN CONCRETE IN MONUMENT WELL

FOUND AND SET POINTS AS SHOWN ON PAGE 2.

THIS POINT WAS REFERENCED PRIOR TO A CONSTRUCTION PROJECT IN THE VICINITY.

THE TIES SHOWN HEREON ARE FOR THE PURPOSE OF PERPETUATING FOUND MONUMENTATION.

NO CLAIM IS MADE AS TO THE RELATIONSHIP OF THE POINTS OR LINES SHOWN HEREON TO TRUE BOUNDARY LOCATION.

SURVEYOR'S STATEMENT

This Corner Record was prepared by me or under my direction in conformance with

the Professional Land Surveyors' Act on AUGUST 1, 2019.

Signed

P.L.S. or R.C.E. No.

LS 8525

SCOTT V. CUNHA

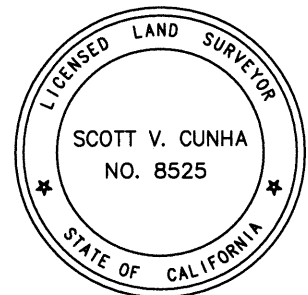

COUNTY SURVEYOR'S STATEMENT

This Corner Record was received October 1, 2019and examined and filed October 4, 2019.

Signed

P.L.S. or R.C.E. No.

9032Title Interim County Surveyor

County Surveyor's Comment

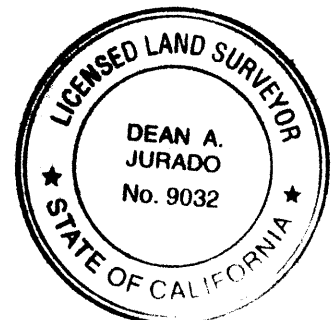

SCALE: 1"=30'

LEGEND

- FOUND IRON PIN IN CONCRETE IN MONUMENT WELL
- ⊗ SET CUT CROSS IN CURB AT DRIVEWAY
- ✕ SET CUT CROSS IN CURB
- ✕ SET CUT CROSS IN BACK OF RAMP

(19592) REFERENCE STREET ADDRESS

