

**BASIS OF BEARINGS**

TRACT 2084, EDEN TOWNSHIP,  
ALAMEDA COUNTY, CALIFORNIA

**LEGEND**

- EXISTING MONUMENT
- CONCRETE MONUMENT WITH CAST IRON FRAME AND COVER - TO BE INSTALLED
- ANCHOR EASEMENT (SEE DETAIL BELOW)

**BUILDING SET-BACK LINES**

BUILDING SET-BACK LINES TO BE AS REQUIRED BY THE ORDINANCE CODE OF THE COUNTY OF ALAMEDA, TITLE 9, CHAPTER 2.

**ANCHOR EASEMENT DETAIL**

(NOT DRAWN TO SCALE)

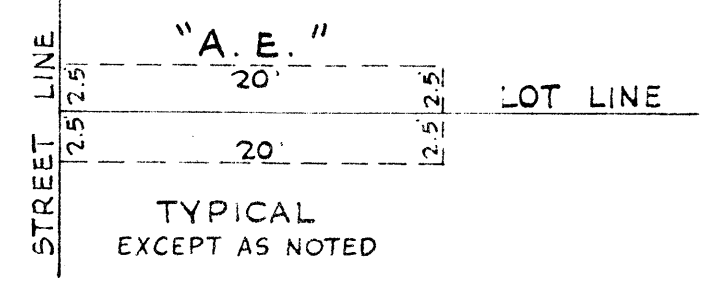

**\* USE WITH CAUTION \***  
THIS IS A PUBLIC WORKS DEPARTMENT  
WORKING COPY OF AN OFFICIAL MAP  
ON FILE IN THE OFFICE OF THE COUNTY  
RECORDER, COUNTY OF ALAMEDA. OF  
FICE INFORMATION OR CALCULATIONS  
MAY HAVE BEEN ADDED HEREON.

This is a copy of a map on file in the Recorder's Office of Alameda County. No representation of any kind is made as to the accuracy of the original official map from which this is copied, and this copy carries with it no representation of any kind other than that it is a copy.

Any questions concerning this map should be directed to the Recorder's Office of Alameda County.  
DIETERICH POST COMPANY

**TRACT 2478**  
**EDEN TOWNSHIP**  
**ALAMEDA COUNTY, CALIFORNIA**  
IN UNINCORPORATED TERRITORY IN THE COUNTY OF ALAMEDA  
SCALE: 1" = 100'  
APRIL, 1965  
MURRAY & McCORMICK, INC.  
CONSULTING CIVIL ENGINEERS  
SAN LEANDRO, CALIFORNIA  
SHEET 3 OF 7 SHEETS